

Installation Instructions: Tubular leversets

1 Technical specifications

1.1 Tools recommended

Table 1

#2 and #3 Phillips screwdriver	Tape measure	1" (25.4 mm) hole saw	1" (25.4 mm) wood chisel
Flat screwdriver	2-1/8" (54 mm) hole saw	Pencil	Drill

1.2 Overview

Fig.1

Latch backset adjustment

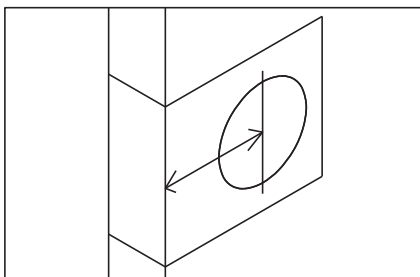

NOTE: The backset is the distance from the door edge to the center of the hole on the door face. Some locks are supplied with an adjustable latch which can fit a 2-3/8" (60 mm) or a 2-3/4" (70 mm) backset.

Fig.2

Adjustable latch for a 2-3/8" (60 mm) and a 2-3/4" (70 mm) backset
Follow the steps shown here to change the backset.

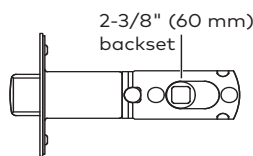

1.2.1 This latch is set for a 2-3/8" (60 mm) backset.

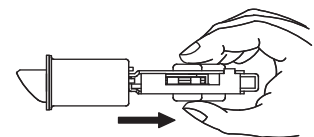

1.2.2 Keep the spindle cam in the correct position as illustrated. Pull the spindle cam all the way to the right.

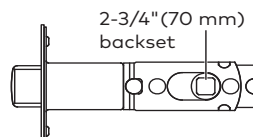

1.2.3 Your latch is now set for a 2-3/4" (70 mm) backset. To reset to 2-3/8" (60 mm) backset, push the spindle cam back to the left side. Please make sure that the cams align with the square shape.

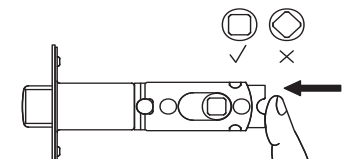

Latch faceplate

Fig.3

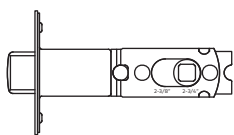

NOTE: Locks are supplied with a 4-way latch which can fit a square or a radius corner faceplate.

1.2.4 This latch is for the radius corner.

Replace latch faceplate

Fig.4

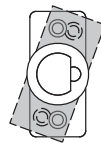

1.2.5 Replace the radius corner faceplate if a square corner is required.

Fig.5

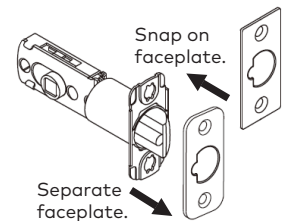

1.2.6 Use a flat screwdriver to separate the faceplate.
1.2.7 Snap the selected faceplate onto the backplate.

2 Installation instructions

2.1 Mark door with template.

Fig.6

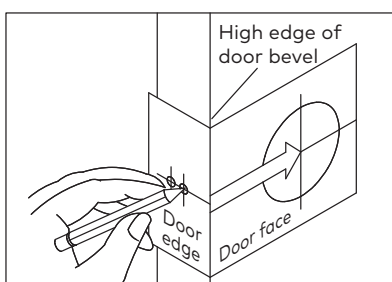

- 2.1.1 Fold the template along the dashed line and tape it in position on the high edge of the door.
- 2.1.2 Mark the drill point for the center of the door edge.
- 2.1.3 Select a 2-3/8" (60 mm) or a 2-3/4" (70 mm) backset as desired.
- 2.1.4 Mark the drill point for the center of the hole on the door face.

2.2 Drill holes.

Fig.7

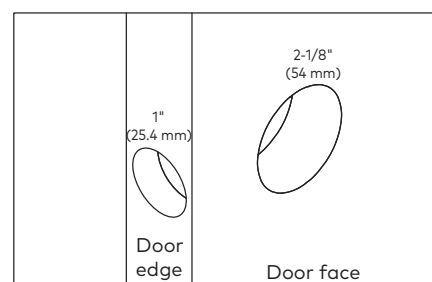

- 2.2.1 Drill a 2-1/8" (54 mm) dia. hole on the door face, from both sides to avoid wood splitting.
- 2.2.2 Drill a 1" (25.4 mm) dia. hole on the door edge for the latch.

Template to scale 1 : 1, full size.

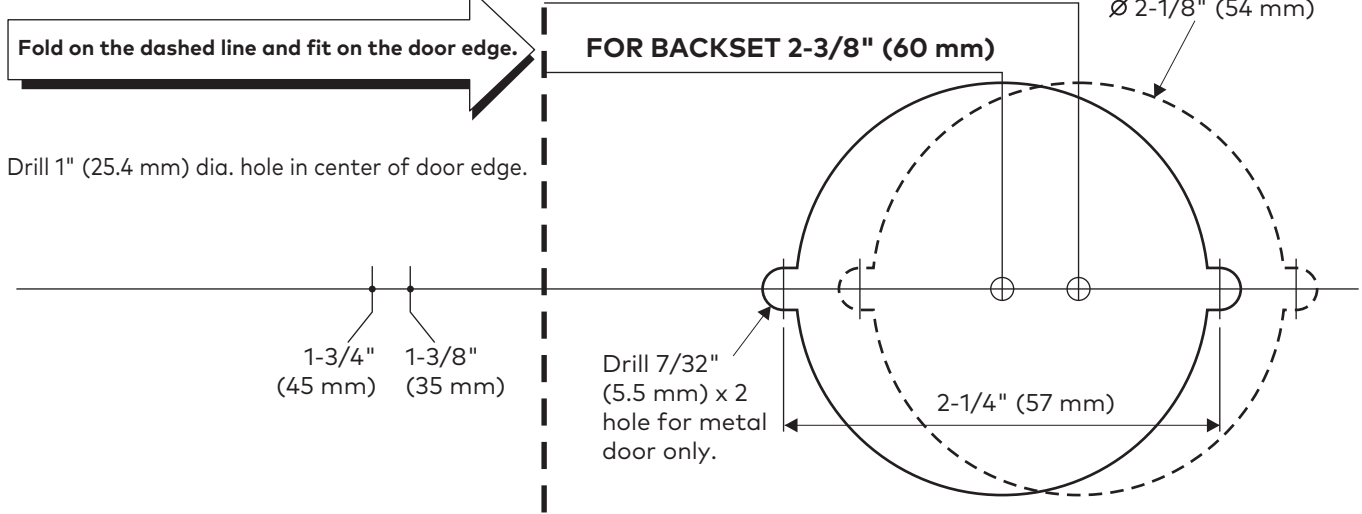

2.3 Install latch.

Fig.8

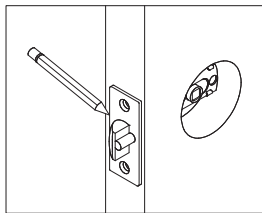

2.3.1 Insert the latch into the hole and keep it parallel to the door face.

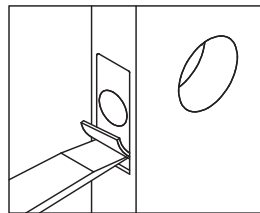

2.3.2 Mark the outline of the faceplate and remove the latch.

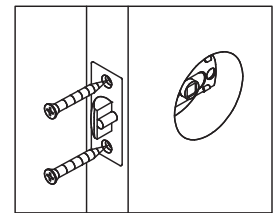

2.3.4 Insert the latch and tighten the screws.

2.3.3 Chisel to a depth of 5/32" (4 mm) or until the faceplate is flush with the door edge.

2.4 Install outside lever.

Fig.9

Guide pin location

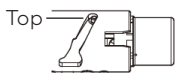

✓ **Unlock position (Factory preset)**



✗ **Lock position**

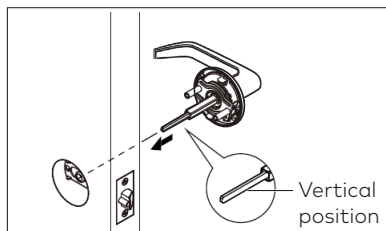

2.4.1 Reset to unlock position if locked.
2.4.2 Orient the spindle vertically and insert through the latch and press flush against the door.

2.5 Install inside lever.

Fig.10

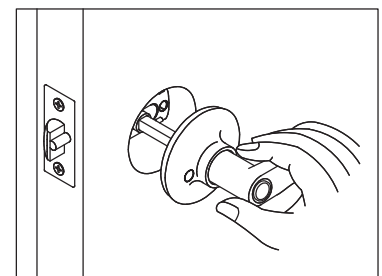

2.5.1 Install the inside lever and tighten the screws until the lock is firm.

2.6 Install strike.

Fig.11

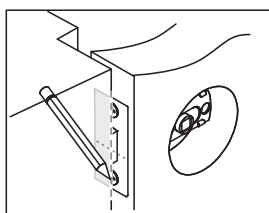

2.6.1 Close the door to locate the horizontal centerline of the strike.
2.6.2 Measure one half of the door thickness from the door stop and mark the vertical centerline of the strike.

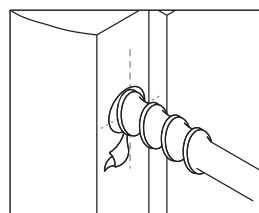

2.6.3 Drill a 1" (25.4 mm) hole, 1/2" (13 mm) deep at the intersection of the horizontal and the vertical lines of the strike.
2.6.4 Match the screw holes on the strike with the centerlines on the jamb.

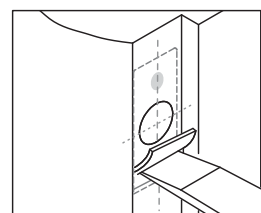

2.6.5 Mark the outline of the strike and chisel 1/16" (1.6 mm) deep.
2.6.6 Install the strike and tighten the screws.

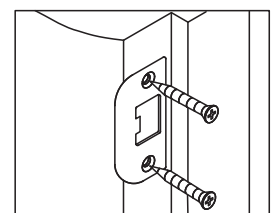

For online instructions visit:
<https://dhwsupport.dormakaba.com/hc/en-us>
For assistance or warranty information:
Call 1-800-392-5209 or visit
<https://dhwsupport.dormakaba.com/hc/en-us>